

MODULA OFFICE WITH WC

DIMENSION M 5,90 X 2,30 X 2,23 H NET INSIDE

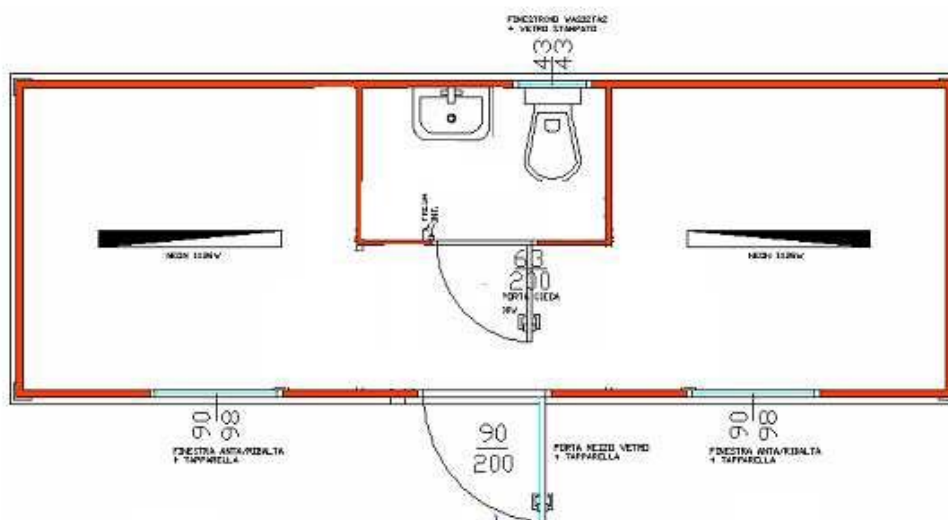

TECHNICAL DETAILS:

STRUCTURE: it is made up by base and roofing section bars, which are connected through angular uprights. It is an all **steel** unit with appropriate **thickness of 15/10**, zinc-plated sheets, electro welding, protected coated cycle on sight parts, color RAL 3028.

WALLS: Sandwich type modular panels, self-carrying walls, having prevarnished white-grey and fret-plated sheets (thickness 5/10) on both sides, insulated inside expanded foam polyurethane (density 40 kg/cm). The panels are supported by strong profiles, of a proportionate thickness, serving as an upper and lower crowning frame, connected through male-female joints, which are properly and hermetically sealed, in order to be waterproof.

The sheet of the panels is zinc-plated and firevarnished.

The external panels are 40 mm thickness,

CEILING: horizontal ceiling, whose panels have got the same features of those used for the floor. Fret sheet upper wall: flat **thickness 30 mm., fret thickness 70** mm. The roof is walking area, load capacity is about 200 kg./sqm.

FLOOR: PVC floor fixed with a special glue to a waterproof chipboard panel (thickness 18 mm) then fixed to a frame. The frame is made up of a zinc-plated tubular.



ZULIANI Elvio srl - Building Equipments

Via Zorutti, 80 - 33030 Campoformido (UD) Italia

ph. +39 0432-662448 - fax. +39 0432-662449

info@ez-group.it

www.ez-group.it

FIXTURES AND WINDOWS: aluminium, natural white electro varnished, or in PVC, **equipped with 4 MM glasses**, with base safety bars

Windows, door locks, door handles and dust resistant gummy seals.

- 01 external door cm 90 x 200 (free space), 1/2 with window
- 02 sliding windows cm 90 x 98 (free space) with safety bars
- 01 wasistas window cm 43 x 43 with printed glass

ELECTRICAL SYSTEM: complete and well functioning electrical system, provided with visible cables trough the inside walls, according to the regulations in force.

- 02 NEON LAMP 1x36 watt
- 02 socket
- 01 switch
- 01 switch-board equipped with magneto thermal safety device, ground wire switches - outside watertight box 110 Volt / 60 HERTZ, TOTAL 3 KW POWER

HIDRAULIC SYSTEM: complete, provided with visible pipes fixed to the walls.

- 01 sink in ABS with cold water robinet
- 01 Englis ceramic wc